

Job Name _____

Contractor _____

Job Location _____

Approval _____

Engineer _____

Contractor's P.O. No. _____

Approval _____

Representative _____

LEAD FREE*



AquaLock™ Plastic Couplings and Adapters

Watts AquaLock push-to-connect Couplings and Adapters are designed and manufactured for many years of trouble free service. Produced of off white Polysulfone, a high performance thermal plastic material, the Watts AquaLock push-to-connect design allows for quick and easy connections without the use of installation tools.

Specifications

Connection shall be made using Watts AquaLock Plastic fitting with Integral Collet and O-Ring guide. Fitting shall be able to fully rotate under pressure and allow for easy disconnect and reuse without the use of disconnection tools. Fitting must not disassemble to disconnect.

Approvals

NSF-61, NSF-14, CSA B137.5, ASTM F877, UPC, ASSE 1061

Ratings

100psi @ 180°F (6.8 bar @ 82°C)
250psi @ 75°F (17.3 bar @ 24°C)

Example

3501-0806
35 = Plastic
01 = Male Adapter
0806 = 3/8" CTS x 3/8" NPT



CAUTION

The polysulfone material used in the AquaLock™ fittings can be compromised by exposure to volatile organic compounds (VOC's) and caustic chemicals. Therefore, **DO NOT** expose this product to any such chemical or foreign substance, which would include exposure to the following products: **Pipe Dopes (thread sealants)**, bug sprays, lubricants, cleaners, paints, bleaches, acids, solder fluxes, plastic piping primers and cements, oxidizing agents, alkaline solutions, thinners, fuels, oil based caulks, hydrocarbons, spray foam or foaming agents (insulation). It is also recommended that all threaded connections be made with Teflon® tape only.

NOTICE

The information contained herein is not intended to replace the full product installation and safety information available or the experience of a trained product installer. You are required to thoroughly read all installation instructions and product safety information before beginning the installation of this product.

*The wetted surface of this product contacted by consumable water contains less than 0.25% of lead by weight.



Watts product specifications in U.S. customary units and metric are approximate and are provided for reference only. For precise measurements, please contact Watts Technical Service. Watts reserves the right to change or modify product design, construction, specifications, or materials without prior notice and without incurring any obligation to make such changes and modifications on Watts products previously or subsequently sold.



Dimensions – Weights – Weight and Dimensions are approximate (tolerance +/- 1/8)

Male Adapter

MODEL	ORDERING CODE	SIZE & CONNECTION	ITEM LENGTH		ITEM HEIGHT		ITEM WEIGHT	
			in.	mm	in.	mm	oz.	gr.
Package Type: Single Pack								
3501-0806	0959033	3/8" CTS x 3/8" NPT	1 3/4	44	1	25	0.32	9.07
3501-1006	0959269	1/2" CTS x 3/8" NPT	2	51	1 1/8	29	0.48	13.61
3501-0808	0959034	3/8" CTS x 1/2" NPT	2	51	1 5/16	24	0.4	11.34
3501-1008	0959083	1/2" CTS x 1/2" NPT	2	51	1 1/8	29	0.6	17.01
3501-1012	0959084	1/2" CTS x 3/4" NPT	2 1/8	54	1 1/8	29	0.7	19.85
3501-1014	0959290	1/2" CTS x 3/4" MGHT	2 1/8	54	1 1/8	29	0.7	19.85
3501-1412	0959136	3/4" CTS x 3/4" NPT	2 1/2	64	1 3/8	35	1.1	31.19
3501-1416	0959788	3/4" CTS x 1" NPT	2 3/4	64.85	1 3/4	45	1.5	42.5
3501-1816	0959301	1" CTS x 1" NPT	3	76	1 3/4	45	1.63	46.21

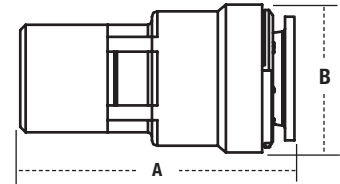

Package Type: Bulk Pack

3501-0806CP	81902877	3/8" CTS x 3/8" NPT	1 3/4	44	1	25	0.32	9.07
3501-1006CP	81902879	1/2" CTS x 3/8" NPT	2	51	1 1/8	29	0.48	13.61
3501-0808CP	81902878	3/8" CTS x 1/2" NPT	2	51	1 5/16	24	0.4	11.34
3501-1008CP	81902880	1/2" CTS x 1/2" NPT	2	51	1 1/8	29	0.6	17.01
3501-1012CP	81902882	1/2" CTS x 3/4" NPT	2 1/8	54	1 1/8	29	0.7	19.85
3501-1014CP	81902883	1/2" CTS x 3/4" MGHT	2 1/8	54	1 1/8	29	0.7	19.85
3501-1412CP	81902885	3/4" CTS x 3/4" NPT	2 1/2	64	1 3/8	35	1.1	31.19
3501-1416CP	81906544	3/4" CTS x 1" NPT	2 3/4	69.85	1 3/4	45	1.5	42.5
3501-1816CP	81902887	1" CTS x 1" NPT	3	76	1 3/4	45	1.63	46.21

Female Adapter

MODEL	ORDERING CODE	SIZE & CONNECTION	ITEM LENGTH		ITEM HEIGHT		ITEM WEIGHT	
			in.	mm	in.	mm	oz.	gr.
Package Type: Single Pack								
3510-0808	0959790	3/8" CTS x 1/2" NPS	1 7/8	48	1 1/4	32	0.6	17.01
3510-1008	0959085	1/2" CTS x 1/2" NPS	2 1/8	54	1 1/8	29	0.7	19.85
3510-1012	0959086	1/2" CTS x 3/4" NPS	2 3/16	56	1 5/16	33	1	28.35
3510-1013	0959292	1/2" CTS x 3/4" Closet	2 5/16	59	1 5/8	41	0.9	25.52
3510-1014	0959235	1/2" CTS x 3/4" FGHT	2 1/8	54	1 5/16	33	1.2	34.02
3510-1412	0959137	3/4" CTS x 3/4" NPS	2 5/16	59	1 3/8	35	1.2	34.02
3510-1416	0954789	3/4" CTS x 1" NPS	2 1/4	57	1 3/4	45	1.7	48.19
3510-1816	0959298	1" CTS x 1" NPS	2 1/4	57	1 3/4	45	1.7	48.19

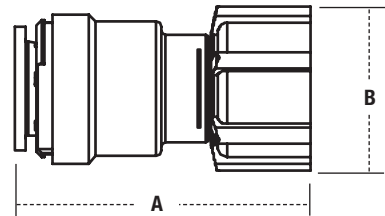

Package Type: Bulk Pack

3510-0808CP	81902888	3/8" CTS x 1/2" NPS	1 7/8	48	1 1/4	32	0.6	17.01
3510-0814CP	81402890	3/8" CTS x 3/4" GHT	2	50.8	1 1/8	29	0.6	17.01
3510-1008CP	81902891	1/2" CTS x 1/2" NPS	2 1/8	54	1 1/8	29	0.7	19.85
3510-1012CP	81902894	1/2" CTS x 3/4" NPS	2 3/16	56	1 5/16	33	1	28.35
3510-1013CP	81902895	1/2" CTS x 3/4" Closet	2 5/16	59	1 5/8	41	0.9	25.52
3510-1014CP	81902896	1/2" CTS x 3/4" FGHT	2 1/8	54	1 5/16	33	1.2	34.02
3510-1412CP	81902897	3/4" CTS x 3/4" NPS	2 5/16	59	1 3/8	35	1.2	34.02
3510-1816CP	81902899	1" CTS x 1" NPS	2 1/4	57	1 3/4	45	1.7	48.19

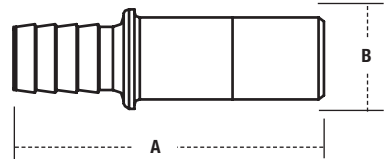

Hose Barb Stem

MODEL	ORDERING CODE	SIZE & CONNECTION	ITEM LENGTH		ITEM HEIGHT		ITEM WEIGHT	
			in.	mm	in.	mm	oz.	gr.

Package Type: Singles Pack

3511-1008	09594171	1/2" CTS x 1/2" Barb	2 5/16	59	.7	18	0.3	8.51
-----------	----------	----------------------	--------	----	----	----	-----	------

Package Type: Bulk Pack

3511-1008CP	81906548	1/2" CTS x 1/2" Barb	2 5/16	59	.7	18	0.3	8.51
-------------	----------	----------------------	--------	----	----	----	-----	------

Hose Barb Adapter

MODEL	ORDERING CODE	SIZE & CONNECTION	ITEM LENGTH		ITEM HEIGHT		ITEM WEIGHT	
			in.	mm	in.	mm	oz.	gr.

Package Type: Single Pack

3513-1008	0954291	1/2" CTS x 1/2" Barb	2 5/16	59	1 1/8	29	0.6	17.01
3513-1412	0959477	3/4" CTS x 3/4" Barb	2 1/2	64	1 1/2	38	1	28.35
3513-1816	0959478	1" CTS x 1" Barb	3	76	1 3/4	45	1.3	36.85

Package Type: Bulk Pack

3513-1008CP	81902904	1/2" CTS x 1/2" Barb	2 5/16	59	1 1/8	29	0.6	17.01
3513-1412CP	81902906	3/4" CTS x 3/4" Barb	2 1/2	64	1 1/2	38	1	28.35

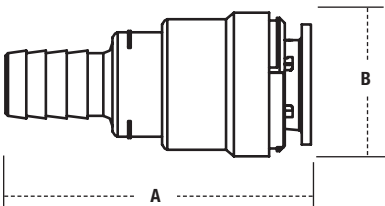

Reducing Stems

MODEL	ORDERING CODE	SIZE & CONNECTION	ITEM LENGTH		ITEM HEIGHT		ITEM WEIGHT	
			in.	mm	in.	mm	oz.	gr.
Package Type: Single Pack								
3514-1008	0959082	1/2" CTS x 3/8" CTS	21/2	64	15/16	24	0.5	14.18
3514-1410	0959135	3/4" CTS x 1/2" CTS	213/16	71	11/8	29	0.6	17.01
3514-1810	0959407	1" CTS x 1/2" CTS	23/4	70	13/16	30	0.8	22.68
3514-1814	0959294	1" CTS x 3/4" CTS	23/4	70	11/2	38	1.1	31.19
Package Type: Bulk Pack								
3514-1008CP	81902908	1/2" CTS x 3/8" CTS	21/2	64	15/16	24	0.5	14.18
3514-1410CP	81902909	3/4" CTS x 1/2" CTS	213/16	71	11/8	29	0.6	17.01
3514-1810CP	81902911	1" CTS x 1/2" CTS	23/4	70	13/16	30	0.8	22.68
3514-1814CP	81902912	1" CTS x 3/4" CTS	23/4	70	11/2	38	1.1	31.19

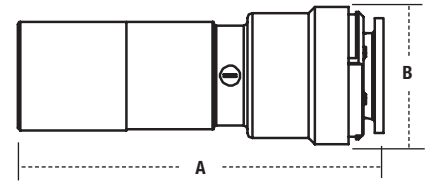

Couplings

MODEL	ORDERING CODE	SIZE & CONNECTION	ITEM LENGTH		ITEM HEIGHT		ITEM WEIGHT	
			in.	mm	in.	mm	oz.	gr.
Package Type: Single Pack								
3515-08	0959032	3/8" CTS	21/4	57	15/16	24	0.5	14.18
3515-10	0959079	1/2" CTS	211/16	68	11/8	29	0.8	22.68
3515-14	0959133	3/4" CTS	31/8	79	13/8	35	1.5	42.52
3515-18	0959299	1" CTS	3	76	11/2	38	2.4	68.04
Package Type: Bulk Pack								
3515-08CP	81902913	3/8" CTS	21/4	51	15/16	24	0.5	14.18
3515-10CP	81902914	1/2" CTS	211/16	68	11/8	29	0.8	22.68
3515-14CP	81902916	3/4" CTS	31/8	79	13/8	35	1.5	42.52
3515-18CP	81902918	1" CTS	3	76	1/2	38	2.4	68.04

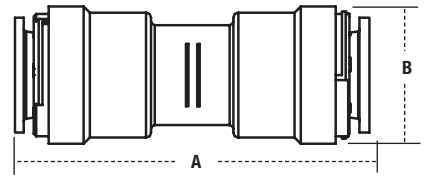

Reducing Couplings

MODEL	ORDERING CODE	SIZE & CONNECTION	ITEM LENGTH		ITEM HEIGHT		ITEM WEIGHT	
			in.	mm	in.	mm	oz.	gr.
Package Type: Single Pack								
3515R-1004	0959080	1/2" CTS x 1/4" OD	213/16	71	11/8	29	0.8	22.68
3515R-1008	0959081	1/2" CTS x 3/8" CTS	21/2	64	11/8	29	0.7	19.85
3515R-1410	0959134	3/4" CTS x 1/2" CTS	3	76	11/2	38	1.2	34.02
3515R-1814	0959793	1" CTS x 3/4" CTS	31/4	83	11/2	38	2	56.70
Package Type: Bulk Pack								
3515R-1004CP	81902924	1/2" CTS x 1/4" OD	213/16	71	11/8	29	0.8	22.68
3515R-1008CP	81902925	1/2" CTS x 3/8" CTS	21/2	64	11/8	29	0.7	19.85
3515R-1410CP	81902926	3/4" CTS x 1/2" CTS	3	76	11/2	38	1.2	34.02
3515R-1814CP	81902927	1" CTS x 3/4" CTS	31/4	83	11/2	38	2	56.70

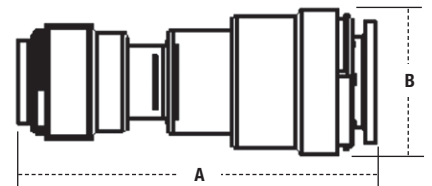

USA: T: (978) 689-6066 • F: (978) 975-8350 • Watts.com
 Canada: T: (905) 332-4090 • F: (905) 332-7068 • Watts.ca
 Latin America: T: (52) 55-4122-0138 • Watts.com