

# Truckin' Reliable Gas Connectors



## Blue Hose<sup>®</sup> Food Truck Gas Connector



Rated for performance in temperatures as low as -10° F (-23° C).



Enhanced coating provides UV and antimicrobial protection.



Fulfills IFC 2018 and 2021 food truck gas appliance connection requirements



Discover the Best  
Truckin' Gas Connectors

**Dormont**<sup>®</sup>  
A WATTS Brand

# Blue Hose<sup>®</sup>

## Food Truck Gas Connector

Your customers count on you to deliver safe, reliable, code-compliant food trucks that stand up to the wear and tear of everyday operation. Now, wherever your customers are, our Blue Hose goes!

- Enhanced antimicrobial coating inhibits growth of bacteria, mold and mildew, and features built in UV protection
- Rated for temperatures as low as -10° F (-23° C)

### What's Included In-Box?



**Blue Hose<sup>®</sup>**  
Food Truck Gas Connector



**Full Port Shutoff Valve**

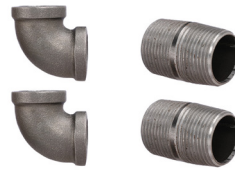

**F x F Elbows + Pipe Nipples\***



**90° Street Elbows\***

\*Contents vary depending on US or Canadian Applications.

ORDERING INFORMATION			
SIZE I.D.	LENGTH		
	36" (914 mm)	48" (1,219 mm)	60" (1,524 mm)
1/2"	1650BPV36BXFT	1650BPV48BXFT	1650BPV60BXFT
3/4"	1675BPV36BXFT	1675BPV48BXFT	1675BPV60BXFT
1"	16100BPV36BXFT	16100BPV48BXFT	16100BPV60BXFT

BTU/HR FLOW CAPACITY NATURAL GAS (FLOW RATING BTU/HR 0.64 SP. GR. @ 0.5 INCH WC PRESSURE DROP)				
MODEL	SIZE I.D.	LENGTH		
		36" (914 mm)	48" (1,219 mm)	60" (1,524 mm)
1650BPFT	1/2"	120,000	106,000	93,000
1675BPFT	3/4"	256,000	225,000	198,000
16100BPFT	1"	512,000	451,000	397,000

### CODE ALERT

Fulfills Requirement in IFC 2018 and IFC 2021 calling for a moveable gas appliance connector complying with ANSI Z21.69/CSA 6.16 for Food Truck gas cooking appliance connections



USA: T: (800) 367-6668 • F: (724) 733-4808 • Dormont.com