

# Engineering Specification

Job Name \_\_\_\_\_  
 Job Location \_\_\_\_\_  
 Engineer \_\_\_\_\_  
 Approval \_\_\_\_\_

Contractor \_\_\_\_\_  
 Approval \_\_\_\_\_  
 Contractor's P.O. No. \_\_\_\_\_  
 Representative \_\_\_\_\_

## FD-470-F 15" x 15" Shallow Body Promenade Drain

### Specification

Watts FD-470-F epoxy coated cast iron promenade drain with flashing flange, weepholes, 15 5/8" x 15 5/8"(397x397) solid nickel bronze grate and no hub outlet.

Call customer service if you need assistance with technical details.

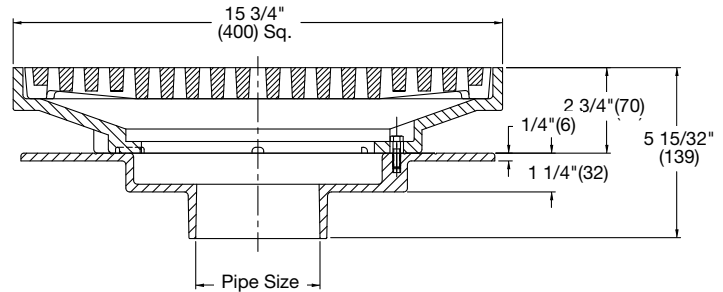

Pipe Sizing		
Suffix	Description	
2	2"(51) Pipe Size	<input type="checkbox"/>
3	3"(76) Pipe Size	<input type="checkbox"/>
4	4"(102) Pipe Size	<input type="checkbox"/>
6	6"(152) Pipe Size	<input type="checkbox"/>
8	8"(203) Pipe Size	<input type="checkbox"/>

Outlet Type		
Suffix	Description	
NH	No Hub (MJ)	<input type="checkbox"/>
-P	Push On	<input type="checkbox"/>
-T	Threaded Outlet	<input type="checkbox"/>
-X	Inside Caulk	<input type="checkbox"/>

Grate		
Suffix	Description	
F-1	15"x15"(381x381) Solid Nickel Bronze	<input type="checkbox"/>
F-3	15"x15"(381x381) SS Veneer	<input type="checkbox"/>
F-4	15"x15"(381x381) Ductile Iron	<input type="checkbox"/>

Options		
Suffix	Description	
-5	Sediment Bucket	<input type="checkbox"/>
-6	Vandal Proof	<input type="checkbox"/>
-7	Trap Primer Tapping	<input type="checkbox"/>
-8	Backwater Valve 3" & 4" only	<input type="checkbox"/>
-9	Hinged Grate	<input type="checkbox"/>
-10	Secured Top c/w Phillips Screws	<input type="checkbox"/>
-12	Hot Dipped Galvanized	<input type="checkbox"/>
-13	Painted Galvanized	<input type="checkbox"/>
-26	Hinged Locking Grate	<input type="checkbox"/>
-34	Closure Plug	<input type="checkbox"/>
-113M	Special Epoxy from 3M Range	<input type="checkbox"/>
-S0	Side Outlet	<input type="checkbox"/>
-Z	Elastomeric Flange	<input type="checkbox"/>

Suffix	Load Rating	Free Area Sq. In.
F-1	*XHD	57
F-3	*XHD	57
F-4	*XHD	57

### NOTICE

The information contained herein is not intended to replace the full product installation and safety information available or the experience of a trained product installer. You are required to thoroughly read all installation instructions and product safety information before beginning the installation of this product.

### NOTICE

The load classifications are in accordance with the American National Standards ASME A112.21.1M ASME ratings are as follows:  
 XHD Safe Live Load 7500 - 10,000 lbs. (3375 - 4500kg)  
 The above categories are given as a guide only. Consult factory.

Watts product specifications in U.S. customary units and metric are approximate and are provided for reference only. For precise measurements, please contact Watts Technical Service. Watts reserves the right to change or modify product design, construction, specifications, or materials without prior notice and without incurring any obligation to make such changes and modifications on Watts products previously or subsequently sold.



USA: T: (800) 338-2581 • Watts.com  
 Canada: T: (888) 208-8927 • Watts.ca  
 Latin America: T: (52) 55-4122-0138 • Watts.com