

For Commercial, Residential and Industrial Applications

Job Name _____

Contractor _____

Job Location _____

Approval _____

Engineer _____

Contractor's P.O. No. _____

Approval _____

Representative _____

Series WBVC-M1

2 Piece, Standard Port, Brass Ball Valves

Sizes: 1/2" – 1" (15 – 25mm)

Series WBVC-M1 2-Piece, Standard Port, Brass Ball Valves are ideal for a full range of liquids in commercial, residential and industrial applications. This Series features compression connections and a brass body.

Features

- NSF 61
- Compression connections
- Brass body
- Ideal for a full range of liquids in commercial, residential and industrial applications

Specifications

A 2-piece standard port brass ball valve with NSF 61 approval shall be installed as indicated on the plans. The valve shall be pressure rated to 400psi (28 bar) WOG non-shock; 150psi (10.3 bar) WSP. The valve shall have compression connections. Valve shall be a Watts Series WBVC-M1.

Pressure – Temperature

Temperature Range: 40°F - 366°F (4°C – 186°C)

Maximum Working Pressure: 400psi (28 bar) WOG non-shock; 150psi (10.3 bar) WSP

Dimensions – Weights

SIZE (DN)		DIMENSIONS						WEIGHT					
in.	mm	A		B		C		D		E			
		in.	mm	in.	mm	in.	mm	in.	mm	in.	mm		
1/2	15	27/8	73.7	111/16	43.4	3/8	10.0	37/16	86.9	15/16	23.6	0.51	0.2
3/4	20	31/4	83.1	17/8	48.3	9/16	15.0	311/16	93.0	1	25.7	0.73	0.3
1	25	35/8	91.9	21/4	57.7	3/4	19.2	45/8	117.0	11/8	29.3	1.17	0.5



WBVC-M1

Materials

Nut	Carbon Steel
Handle	Steel
Packing Nut	Brass
Stem Packing	PTFE
Stem	Brass ASTM B16, C36000
Stem O-Ring	Buna-N
Body	Forged Brass
Seats	PTFE
Ball	Brass
Adapter	Forged Brass B124, C37700
Drain Packing	EPDM
Drain Cap	Brass ASTM B16, C36000
Compression Ring	Brass ASTM B16, C36000
Compression Nut	Brass ASTM B16, C36000

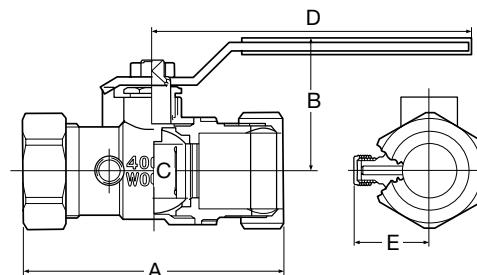

NOTICE

The information contained herein is not intended to replace the full product installation and safety information available or the experience of a trained product installer. You are required to thoroughly read all installation instructions and product safety information before beginning the installation of this product.

Watts product specifications in U.S. customary units and metric are approximate and are provided for reference only. For precise measurements, please contact Watts Technical Service. Watts reserves the right to change or modify product design, construction, specifications, or materials without prior notice and without incurring any obligation to make such changes and modifications on Watts products previously or subsequently sold.

USA: T: (978) 689-6066 • F: (978) 975-8350 • Watts.com

Canada: T: (905) 332-4090 • F: (905) 332-7068 • Watts.ca

Latin America: T: (52) 81-1001-8600 • Watts.com

ES-WBVC-M1 1209

© 2012 Watts